

# GEORGE FOREMAN®

HEALTHY COOKING

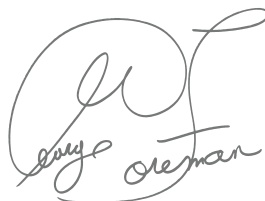

## CITRUS JUICER

Instructions & Warranty

GFCJ631AU

Spectrum Brands Australia Pty Ltd  
Locked Bag 3004 Braeside  
Victoria 3195 Australia  
Customer Service in Australia  
TollFree: 1800 623 118  
Email: info@spectrumbrands.com.au  
Website: www.spectrumbrands.com.au

Spectrum Brands New Zealand Ltd  
PO Box 9817 Newmarket  
Auckland 1149 New Zealand  
Customer Service in New Zealand  
TollFree: 0800 736 776  
Email: service@spectrumbrands.co.nz  
Website: www.spectrumbrands.co.nz

## Spectrum Brands Australia Pty Ltd and Spectrum Brands New Zealand Ltd Warranty Against Defects

In this warranty:

Australian Consumer Law means the Australian consumer law set out in Schedule 2 to the Competition and Consumer Act 2010;

CGA means the New Zealand Consumer Guarantees Act 1993;

Goods means the product or equipment which was accompanied by this warranty and purchased in Australia or New Zealand, as the case may be;

Manufacturer, We or us means:

1. for Goods purchased in Australia, Spectrum Brands Australia Pty Ltd ABN, 78 007 070 573;  
or
2. for Goods purchased in New Zealand, Spectrum Brands New Zealand Ltd, as the case may be, contact details as set out at the end of this warranty;

Supplier means the authorised distributor or retailer of the Goods that sold you the Goods in Australia or in New Zealand; and

You means you, the original end-user purchaser of the Goods.

1. Our goods come with guarantees that cannot be excluded under the Australian Consumer Law, or the CGA. You are entitled to a replacement or refund for a major failure and compensation for any other reasonably foreseeable loss or damage. You are also entitled to have the goods repaired or replaced if the goods fail to be of acceptable quality and the failure does not amount to a major failure.
2. The benefits provided by this Warranty are in addition to all other rights and remedies in respect of the Goods which the consumer has under either the Australian Consumer Law or the CGA. The original purchaser of the Goods is provided with the following Warranty subject to the Warranty Conditions:
3. We warrant the Goods for all parts defective in workmanship or materials from the date of purchase (Warranty Period), for the period of:-
  - (a) Two (2) years for Russell Hobbs products (see product packaging for details)
  - (b) Two (2) years with five (5) year motor warranty for Russell Hobbs products (see product packaging for details)
  - (c) Limited Lifetime, Ten (10) years for Russell Hobbs cookware.
  - (d) One (1) year for George Foreman, iRobot, Westinghouse, Black & Decker and Spectrum Brands products.

If the Goods prove defective within the Warranty Period by reason of improper workmanship or material, we may, at our own discretion, repair or replace the Goods without charge.

## Warranty Conditions

4. The Goods must be used in accordance with the manufacturer's instructions. This Warranty does not apply should the defect in or failure of the Goods be attributable to misuse, abuse, accident or non-observance of manufacturer's instructions on the part of the user. As far as the law permits, the manufacturer does not accept liability for any direct or consequential loss, damage or other expense caused by or arising out of any failure to use the Goods in accordance with the manufacturer's instructions.
5. Exhaustible components (such as batteries, filters and brushes) of the Goods are included under this Warranty only where there is a defect in workmanship or materials used.
6. The warranty granted under clause 3 is limited to repair or replacement only.
7. Any parts of the Goods replaced during repairs or any product replaced remain the property of the manufacturer. In the event of the Goods being replaced during the Warranty Period, the warranty on the replacement Goods will expire on the same date as for the Warranty Period on the original Goods which are replaced.
8. In order to claim under the warranty granted under clause 3 you must:
  - (a) Retain this warranty with your receipt/proof of purchase; and
  - (b) Return the Goods to us at the relevant address or to the Supplier by prepaid freight within the Warranty Period accompanied with (i) the legible and unmodified original proof of purchase, which clearly indicates the name and address of the Supplier, the date and place of purchase, the product name or other product serial number and (ii) this warranty.
9. This warranty is immediately void if:
  - (a) Any serial number or appliance plate is removed or defaced;
  - (b) The Goods have been serviced or otherwise repaired by a person not authorised to do so by us or where non approved replaced parts are used.
10. The Goods are designed for domestic use only. A limited 90-day Warranty applies to any industrial or commercial use of the Goods. The Goods must be connected to the electrical voltage requirements as specified in the ratings label located on the Goods.
11. This warranty does not cover the cost of claiming under the warranty or transport of the Goods to and from the Supplier or us.
12. This warranty is only valid and enforceable in Australia against Spectrum Brands Australia Pty Ltd and in New Zealand against Spectrum Brands New Zealand Ltd.

Contact us or the Supplier for further details.

Register your product online

If you live in Australia please visit: [www.spectrumbrands.com.au/warranty](http://www.spectrumbrands.com.au/warranty)

If you live in New Zealand Please visit: [www.spectrumbrands.co.nz/warranty](http://www.spectrumbrands.co.nz/warranty)

Registration of your warranty is not compulsory, it gives us a record of your purchase AND entitles you to receive these benefits: Product information; Hints and tips; Recipes and news; Information on special price offers and promotions.

Any questions? Please contact Customer Service for advice.

Congratulations on the purchase of your George Foreman Juicer. Each unit is manufactured to ensure safety and reliability. Before using the appliance for the first time, please read the instruction book carefully and keep it for future reference. Pass it on if you pass on the appliance.

When using electrical appliances, basic safety precautions should always be followed.

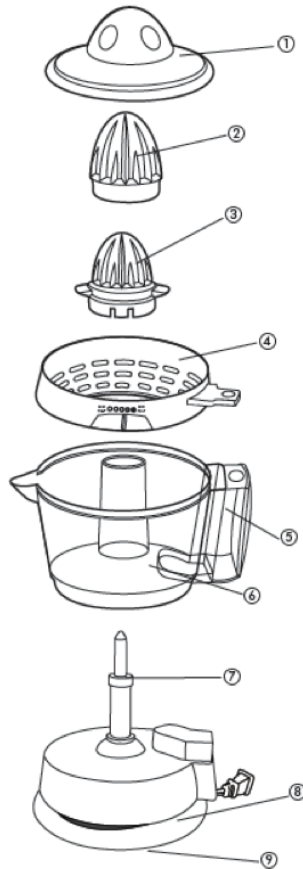

- |  |   |
|--|---|
| 1. Storage cover                           | 6. Clear-view juice container<br>(1 litre / 34oz) |
| 2. Large self-reversing cone               | 7. Base stem                                      |
| 3. Small self-reversing cone with stirrers | 8. Base   |
| 4. Strainer with adjustable pulp control   | 9. Built-in cord wrap                             |
| 5. Handle                                  |   |

## ASSEMBLING YOUR JUICER

### Remove all labels, tags and stickers attached to the body or cord.

1. Place the base stem through the container until the container rests on the base.
2. Place the strainer on top of the container.
3. Choose a self reversing cone.

**Important:** *If choosing the large self-reversing cone, place it on top of the small self-reversing cone. Place the notches of the large cone over the stirrers of the small cone and press to snap into place.*

**Note:** *Small cone is recommended for small fruits such as lemons and large cone for larger fruits such as grapefruits.*

4. Place the base stem through the cone until the cone rests on top of the strainer.

## HOW TO USE

- Wash all parts as instructed in the CARE AND CLEANING section.
- Assemble your juicer as instructed in the ASSEMBLING YOUR JUICER section.
- Unwrap the cord from the base.
- Plug the cord into a standard electrical outlet.
- Adjust pulp control to the desired amount of pulp.
- Cut the fruit in half.
- Place the cut side of the fruit on top of the self-reversing cone.
- Using firm to moderate pressure, press down on the fruit to start the juicing motion.
- Release pressure to stop the self-reversing cone from rotating.

**Important:** *The motor stops automatically when the pressure is completely released.*

- Press down on the fruit again and the self-reversing cone will start rotating in the opposite direction.

**Note:** *Repeat last 3 steps several times for best juicing results .*

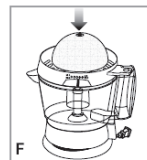
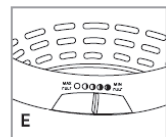
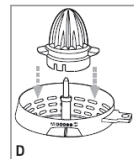
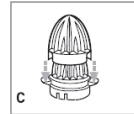
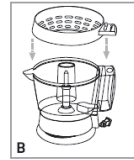
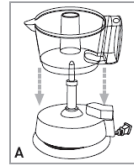

## CARE AND CLEANING

### TO CLEAN

***Caution: To prevent possible damage to the appliance do not use harsh abrasive or alkaline cleaning agents.***

- Always unplug the unit before cleaning or when not in use.
- Remove the cover (first time use), cone and strainer from the container by lifting them straight up.
- Rinse the cone and strainer with water immediately after each use.
- Lift the container straight up.
- Use warm, soapy water to wash all removable parts (cover, cones, strainer and container) or place them in the dishwasher on the top rack.
- Use a bristle brush to remove fine pulp that may remain on the strainer.
- Wipe the base with a damp cloth or sponge; do not immerse in water or place in the dishwasher.
- Dry all parts before reassembling your juicer (see Assembling Your Juicer section).

### TO STORE

- Unplug the unit.
- Wrap the cord around the base of the unit.
- Before reassembling your juicer, make sure all parts are dry (see Assembling Your Juicer section).
- Place storage cover over the juicer to keep it dust free.

## **IMPORTANT SAFEGUARDS**

1. To protect against electric shock do not immerse cord, plug or juicer base of unit in water or liquid of any sort.
2. Do not use outdoors or in damp or moist areas.
3. This appliance is not intended for use by persons (including children) with reduced physical, sensory or mental capabilities, or lack of experience and knowledge, unless they have been given supervision or instruction concerning use of the appliance by a person responsible for their safety.
4. This appliance is NOT a toy. Young children should be supervised to ensure they do NOT play with the appliance.
5. Always turn off and unplug from the wall power outlet when not in use, before fitting or removing parts, and before cleaning the appliance.
6. To disconnect, ensure the appliance switch is set to off, turn off the wall power outlet, then grasp and pull the plug from the wall outlet. Never pull by the cord.
7. Do not operate this appliance with a damaged cord/plug or after the appliance has been dropped, damaged or has malfunctioned in any manner. Contact customer service for replacement, examination, repair or adjustment.
8. If the power cord or appliance is damaged, it must be repaired or replaced by the manufacturer or a suitably qualified person in order to avoid hazard.
9. The use of attachments/accessories not recommended by the appliance manufacturer may cause injuries or damage to the appliance and void warranty.
10. Do not use on an inclined plane or unstable surface.
11. Keep the appliance and the power cord away from the edge of tables or countertops and out of reach of children and infirm persons.
12. Do not use the appliance if the rotating cones are damaged.
13. Care must be taken when handling any accessories with sharp edges.
14. Do not attempt to defeat any safety interlock mechanisms.
15. To prevent possible damage to the appliance do not use harsh abrasive or alkaline cleaning agents.
16. Always clean the appliance after use.
17. Follow the instructions when cleaning this appliance.
18. Do not place on or near any heat sources.
19. Do not leave the appliance unattended when in use.
20. Do not use appliance for other than its intended purpose.
21. This appliance is not a toy. Children should be supervised to ensure they do not play with the appliance.
22. This appliance is not intended to be operated by means of an external timer or separate remote control system.
23. For added safety, electrical appliances should be connected to a power outlet that is protected by a residual current device (RCD), also often referred to as a 'Safety Switch'. Your switchboard may already incorporate an RCD. If unsure, call an electrician for verification and fitting if necessary.

**SAVE THESE INSTRUCTIONS  
THIS APPLIANCE IS FOR HOUSEHOLD USE ONLY**

# GEORGE FOREMAN®

HEALTHY COOKING



[www.georgeforeman.com.au](http://www.georgeforeman.com.au)

[www.georgeforeman.co.nz](http://www.georgeforeman.co.nz)

GEORGE FOREMAN and logo are trade marks of Spectrum Brands, Inc., or one of its subsidiaries.

©2012 Spectrum Brands, Inc.